

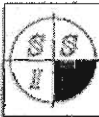

DATE	BY

**A FINAL SUBDIVISION PLAT OF
THE SETTLEMENT PHASE IIIA**
 LOTS 65, 67 THRU 87, 89 AND LOTS 150 THRU 156 SUBDIVISION 422
 OWNED BY KAWAH RESORT ASSOCIATES, L.P.
 LOCATED IN THE TOWN OF KAWAH ISLAND,
 CHARLESTON COUNTY, SOUTH CAROLINA



Southeastern Surveying, Inc.
 147 Haysen Creek Drive - Suite 102
 Charleston, South Carolina 29412
 (803) 795-9330 FAX: 795-2007

NO.	DATE	REVISION

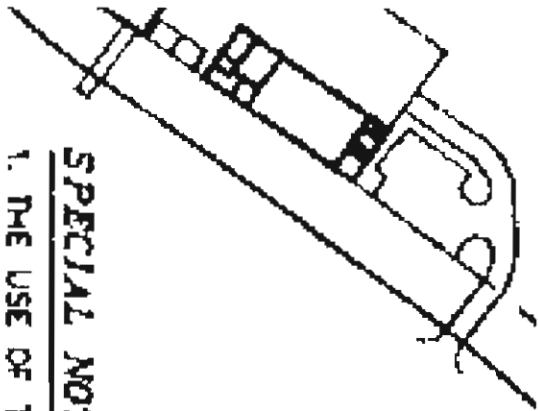

SPECIAL NOTES:

1. THE USE OF THE LOTS DEPICTED HEREON IS SINGLE FAMILY RESIDENTIAL UNLESS OTHERWISE INDICATED.
2. VERTICAL CONTROL BASED ON COAST AND GEODETIC SURVEY NGVD 1929 ESTABLISHED BY DAVIS AND FLOYD ENGINEERS. MONUMENT NO. 294 EL. 5.04 MSL.
3. APPROVAL OF THIS PLAN SHOWING THE ROAD NETWORK WITHIN THE DEVELOPMENT KNOWN AS THE SETTLEMENT, AND IN PARTICULAR THE ILLUSTRATION OF THE INTERSECTION OF KIAWAH ISLAND PARKWAY AND SALTHOUSE LANE (OR UN-NAMED ROAD) SHALL NOT BE CONSTRUED IN ANY MANNER SO AS TO GRANT APPROVAL FOR CONSTRUCTION OF SAID INTERSECTION UNTIL A TRAFFIC STUDY HAS BEEN COMPLETED BY THE TOWN OF KIAWAH ISLAND, AND ANY MITIGATION MEASURES DETERMINED NECESSARY BY THE STUDY HAVE BEEN COMPLETED. THE DEPICTION OF THE INTERSECTION OF KIAWAH ISLAND PARKWAY AND SALTHOUSE LANE (OR UN-NAMED ROAD) ON THIS PLAN SHALL NOT BE CONSTRUED AS INDICATING THE LOCATION WHERE THAT INTERSECTION MAY ULTIMATELY BE CONSTRUCTED.
(SPECIAL NOTE 3. ADDED UNDER PROTEST BY APPLICANT
APPLICANT RESERVES ALL RIGHTS.)

5.
6.
7.
8.

9.

10